

NOTE: LOT 18-21 TO BE DEDICATED TO THE TOWN OF EAGLE MOUNTAIN AND MAINTAINED BY THE HOMEOWNERS ASSOCIATION.

NOTE: ALL OPEN SPACE TO BE STORM DRAIN AND PUBLIC UTILITY EASEMENTS.

SURVEYOR'S CERTIFICATE

I, DAVID V. THOMAS, DO HEREBY CERTIFY THAT I AM A REGISTERED LAND SURVEYOR, AND THAT I HOLD CERTIFICATE NO. 2107, AS PRESCRIBED UNDER THE LAWS OF THE STATE OF UTAH. I FURTHER CERTIFY BY AUTHORITY OF THE OWNERS, I HAVE MADE A SURVEY OF THE TRACT OF LAND SHOWN ON THIS PLAT AND DESCRIBED BELOW, AND HAVE SUBMITTED SAID TRACT OF LAND INTO LOTS, BLOCKS, STREETS, AND EASEMENTS AND THE SAME HAS BEEN CORRECTLY SURVEYED AND STAKED ON THE GROUND AS SHOWN ON THIS PLAT AND THAT THIS PLAT IS TRUE AND CORRECT.

BOUNDARY DESCRIPTION

COMMENCING SOUTH 00°18'58" EAST ALONG THE SECTION LINE 914.20 FEET FROM THE WEST QUARTER CORNER OF SECTION 20, TOWNSHIP 5 SOUTH, RANGE 1 WEST, SALT LAKE BASE & MERIDIAN; THENCE AS FOLLOWS:

BEARING	DISTANCE	REMARKS
S 80°46'45" E	44.01'	
ARC LENGTH	488.53'	CHORD BEARS S 70°43'00" E 426.23' R=1220.00'
S 60°39'14" E	270.39'	
S 28°12'03" W	210.41'	
S 06°02'00" W	865.63'	
S 07°07'33" E	865.11'	
S 12°07'22" E	267.48'	
S 10°26'15" W	314.97'	
ARC LENGTH	65.29'	CHORD BEARS S 89°21'29" E 64.78' R=150.00'
S 76°53'11" E	79.12'	
ARC LENGTH	62.66'	CHORD BEARS S 11°05'06" W 62.23' R=175.00'
N 69°09'24" W	637.33'	
N 00°18'58" W	1621.54'	TO THE POINT OF BEGINNING

AREA = 20.209 ACRES

BASIS OF BEARING = SOUTH 00°18'58" EAST ALONG THE SECTION LINE
 DATE: June 21, 2001
 SURVEYOR: David V. Thomas

EAGLE MOUNTAIN DEVELOPER PLAT DEDICATION

WE, THE UNDERSIGNED OWNERS OF ALL THE REAL PROPERTY DEPICTED ON THIS PLAT AND DESCRIBED IN THE SURVEYOR'S CERTIFICATE ON THIS PLAT, HAVE CALLED THE LAND DESCRIBED ON THIS PLAT TO BE DIVIDED INTO LOTS, STREETS, OPEN SPACES, EASEMENTS AND OTHER PUBLIC USES AS DESIGNATED ON THIS PLAT AND NOW DO HEREBY DEDICATE UNDER THE PROVISIONS OF 10-2-207 UTAH CODE, WITHOUT CONDITION, RESTRICTION TO THE TOWN OF EAGLE MOUNTAIN, UTAH, ALL STREETS, WATER, SEWER AND OTHER UTILITY IMPROVEMENTS, OPEN SPACES SHOWN AS PUBLIC OPEN SPACES PARKS, EASEMENT AND ALL OTHER PLACES OF PUBLIC USE TO THE TOWN OF EAGLE MOUNTAIN, UTAH TOGETHER WITH ALL IMPROVEMENTS REQUIRED BY THE DEVELOPMENT AGREEMENT BETWEEN THE UNDERSIGNED AND THE TOWN OF EAGLE MOUNTAIN FOR THE BENEFIT OF THE TOWN AND THE INHABITANTS THEREOF.

PRINTED NAME OF OWNER: Scott Kinkland
 AUTHORIZED SIGNATURE(S): [Signature]

ACKNOWLEDGMENT

ON THE 21st DAY OF June, 2001, PERSONALLY APPEARED BEFORE ME THE PERSONS SIGNING THE FOREGOING OWNERS DEDICATION KNOWN TO ME TO BE AUTHORIZED TO EXECUTE THE FOREGOING OWNER'S DEDICATION FOR AND ON BEHALF OF THE OWNERS WHO DULY ACKNOWLEDGED TO ME THAT THE OWNER'S DEDICATION WAS EXECUTED BY THEM ON BEHALF OF THE OWNERS.

MY COMMISSION EXPIRES September 20, 2003
 JESSA KAY FINNEN
 NOTARY PUBLIC

ACCEPTANCE BY THE LEGISLATIVE BODY

THE CITY OF EAGLE MOUNTAIN COUNTY OF UTAH, APPROVES THIS SUBDIVISION AND HEREBY ACCEPTS THE DEDICATION OF ALL STREETS, EASEMENTS AND OTHER PUBLIC USES OF LAND INTENDED FOR PUBLIC PURPOSES FOR THE PERPETUAL USE OF THE PUBLIC THIS 8th DAY OF AUGUST, 2001.

PLANNING COMMISSION APPROVAL

APPROVED THIS 8th DAY OF August, A.D. 2001 BY THE EAGLE MOUNTAIN PLANNING COMMISSION.

PLAT "A"

SIMPSON SPRINGS AT RED HAWK RANCH

R1-N1,2(W)

SUBDIVISION

TOWN OF EAGLE MOUNTAIN UTAH COUNTY, UTAH

SCALE: 1" = 80 FEET

CURVE TABLE

CURVE	RADIUS	LENGTH	TANGENT	CHORD	BEARING	DELTA
C1	1226.00	488.53	216.49	426.33	N70°43'00"W	20°07'21"
C2	1226.00	390.18	171.13	388.84	S89°25'47"E	41°28'04"
C3	185.00	320.85	162.39	278.75	S44°41'18"E	142°03'39"
C4	200.00	222.95	116.51	217.86	N07°15'12"E	42°31'24"
C5	200.00	109.00	53.89	107.48	S01°55'28"W	31°12'28"
C6	1026.00	427.80	220.68	420.10	N54°48'28"E	25°22'09"
C7	200.00	212.49	118.17	203.80	S22°42'17"W	61°09'37"
C8	200.00	89.55	45.40	88.54	N41°19'54"E	62°58'13"
C9	15.00	23.56	13.00	21.21	N15°29'14"W	90°00'00"
C10	15.00	23.56	13.00	21.21	S74°20'44"W	90°00'00"
C11	178.00	23.18	11.70	22.99	N41°18'26"E	23°04'19"
C12	225.00	145.25	75.43	143.03	S24°43'10"W	37°02'50"
C13	225.00	94.63	48.02	93.92	S04°10'22"W	24°08'47"
C14	1000.00	232.41	124.88	231.74	N00°39'41"W	14°27'42"
C15	1000.00	20.50	15.37	20.39	S25°58'07"W	17°28'34"
C16	100.00	23.20	14.71	23.10	S08°45'54"W	16°43'52"
C17	225.00	83.16	42.05	82.54	N10°39'14"E	21°10'31"
C18	225.00	86.89	43.68	85.76	N82°33'42"E	21°58'25"
C19	100.00	39.79	20.16	39.52	S32°09'00"W	22°47'59"
C20	100.00	53.78	32.78	52.81	S02°35'59"W	36°18'09"
C21	225.00	75.86	39.80	75.49	N05°06'17"W	19°13'38"
C22	225.00	88.16	44.40	87.41	S14°25'21"E	21°29'41"
C23	225.00	15.54	7.77	15.53	N57°02'49"E	21°47'11"
C24	1000.00	190.38	95.49	190.03	N18°02'19"E	10°54'17"
C25	225.00	122.62	62.88	121.12	S01°52'38"W	31°13'38"
C26	175.00	125.00	62.50	124.71	S07°36'38"W	42°41'39"
C27	150.00	65.44	32.74	65.24	N57°12'07"W	25°04'46"
C28	175.00	9.76	4.88	9.75	N57°12'07"W	25°04'46"
C29	175.00	105.54	52.77	105.23	N18°20'58"W	34°33'19"
C30	175.00	79.93	40.47	79.24	N12°01'06"E	26°10'08"
C31	175.00	10.51	5.25	10.51	S02°06'51"W	21°47'11"
C32	135.00	69.93	35.21	69.09	N31°21'04"E	12°29'48"
C33	275.00	204.38	102.17	199.71	N07°33'42"E	23°15'02"
C34	150.00	308.93	154.43	307.19	S30°29'20"E	118°02'02"
C35	135.00	155.66	77.77	154.18	S24°40'56"E	66°03'44"
C36	135.00	75.19	37.59	74.42	S17°28'16"W	37°22'05"
C37	150.00	34.75	17.38	34.52	S26°24'20"E	13°15'18"
C38	150.00	76.03	38.09	75.88	N75°18'41"E	12°24'24"
C39	100.00	78.14	39.72	77.59	S02°26'49"W	31°20'21"
C40	15.00	21.09	12.48	20.93	N16°41'09"W	30°24'21"
C41	225.00	10.51	5.25	10.51	S02°06'51"W	21°47'11"
C42	200.00	42.83	21.41	42.75	S02°06'51"W	12°16'13"
C43	200.00	25.07	12.53	25.05	S15°42'14"W	07°10'10"
C44	150.00	65.29	32.64	64.78	N89°21'23"W	24°56'24"
C45	175.00	23.84	11.92	23.78	S11°05'06"W	30°29'01"
C46	200.00	194.87	97.44	194.54	N31°59'29"E	05°15'39"
C47	15.00	12.57	6.28	12.54	S02°06'51"W	55°29'49"
C48	200.00	184.07	92.04	183.74	S04°58'41"E	124°24'11"
C49	150.00	27.14	13.57	27.07	N04°00'06"E	53°28'49"
C50	1025.00	38.97	19.49	38.84	N44°27'54"W	124°24'11"
C51	75.00	29.06	14.53	28.97	N06°06'49"E	11°17'28"
C52	210.00	224.21	112.11	223.82	S04°45'45"E	155°08'31"
C53	17.00	27.06	13.53	27.00	N04°06'49"E	11°17'28"
C54	220.00	114.85	57.43	114.52	S02°06'51"W	51°07'20"
C55	150.00	162.94	81.47	162.55	S04°58'41"E	124°24'11"
C56	10.00	27.14	13.57	27.07	N04°00'06"E	53°28'49"
C57	125.00	121.13	60.56	120.74	S04°58'41"E	124°24'11"

LOT ADDRESSSES

LOT	ADDRESS
1	2043 NORTH SIMPSON SPRINGS ROAD
2	2041 NORTH SIMPSON SPRINGS ROAD
3	2106 NORTH SIMPSON SPRINGS ROAD
4	2104 NORTH SIMPSON SPRINGS ROAD
5	2102 NORTH SIMPSON SPRINGS ROAD
6	2100 NORTH SIMPSON SPRINGS ROAD
7	2098 NORTH SIMPSON SPRINGS ROAD
8	2096 NORTH SIMPSON SPRINGS ROAD
9	2094 NORTH SIMPSON SPRINGS ROAD
10	2092 NORTH SIMPSON SPRINGS ROAD
11	2090 NORTH SIMPSON SPRINGS ROAD
12	2088 NORTH SIMPSON SPRINGS ROAD
13	2086 NORTH SIMPSON SPRINGS ROAD
14	2084 NORTH SIMPSON SPRINGS ROAD
15	2082 NORTH SIMPSON SPRINGS ROAD
16	2080 NORTH SIMPSON SPRINGS ROAD
17	2078 NORTH SIMPSON SPRINGS ROAD

LINE TABLE

LINE	BEARING	LENGTH
1	N 89°09'24" W	637.33'
2	N 00°18'58" W	1621.54'
3	S 80°46'45" E	44.01'
4	S 60°39'14" E	270.39'
5	S 28°12'03" W	210.41'
6	S 06°02'00" W	865.63'
7	S 07°07'33" E	865.11'
8	S 12°07'22" E	267.48'
9	S 10°26'15" W	314.97'
10	S 76°53'11" E	79.12'
11	S 11°05'06" W	62.23'
12	N 69°09'24" W	637.33'
13	N 00°18'58" W	1621.54'

STATE PLANE COORDINATES

PT	NORTHING	EASTING
A	742,017.80	1,868,628.74
B	741,103.89	1,865,633.78
C	741,096.84	1,865,677.21
D	740,956.09	1,866,079.50
E	740,823.62	1,866,215.12
F	740,638.24	1,866,215.71
G	740,412.94	1,866,239.79
H	740,124.31	1,866,150.85
I	739,862.87	1,866,207.01
J	739,475.60	1,866,135.67
K	739,482.86	1,865,642.72
L	739,642.82	1,866,898.43
M	739,783.20	1,866,006.09
N	740,246.81	1,863,893.44
O	740,410.18	1,866,008.80

9193-104

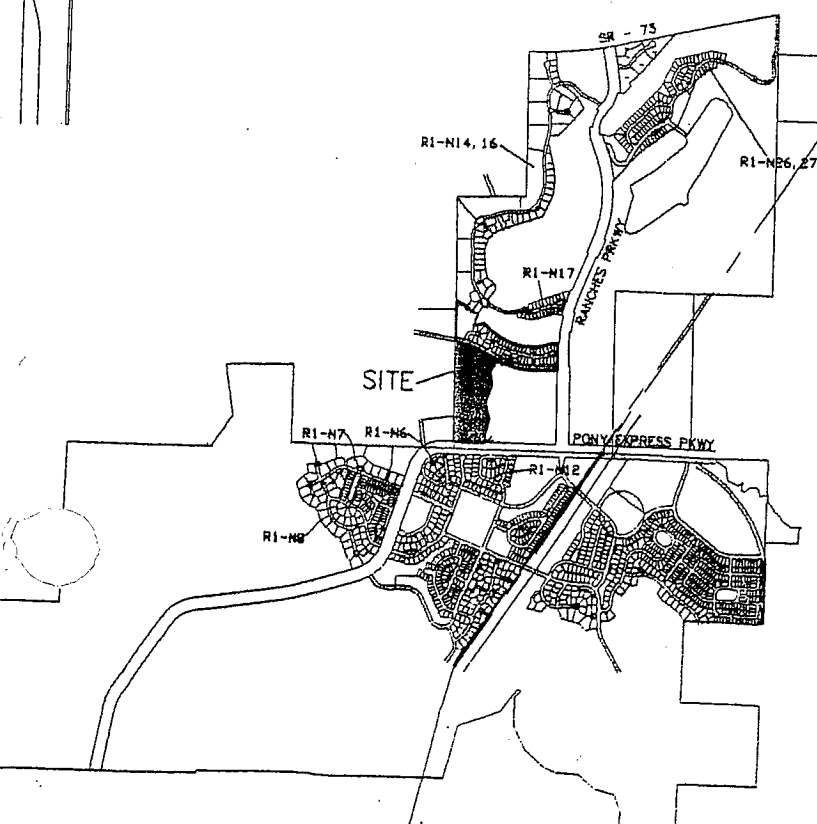

SEC 20, T5S, R14, E22M, TUG-38